

NOTES:

1.0 MATERIAL:

- 1.1 HOUSING AND COUPLING NUT: STAINLESS STEEL PER QQ-S-764 AND ASTM-A582, TYPE 303.
- 1.2 CENTER CONTACT: BERYLLIUM COPPER ROD ALLOY C172 PER ASTM-B196.
- 1.3 BUSHING: HALF HARD BRASS PER ASTM B16

2.0 FINISH:

- 2.1 HOUSING AND COUPLING NUT: PASSIVATED PER SAE AMS QQ-P-35 AND MIL-F-14072.
- 2.2 CENTER CONTACT AND BUSHING: GOLD PER MIL-PRF-39012.

3.0 DIMENSIONS IN PARENTHESIS ARE MILLIMETERS.

4.0 MARK UNIT AS SHOWN.
(REF: INK-09154-27-02)

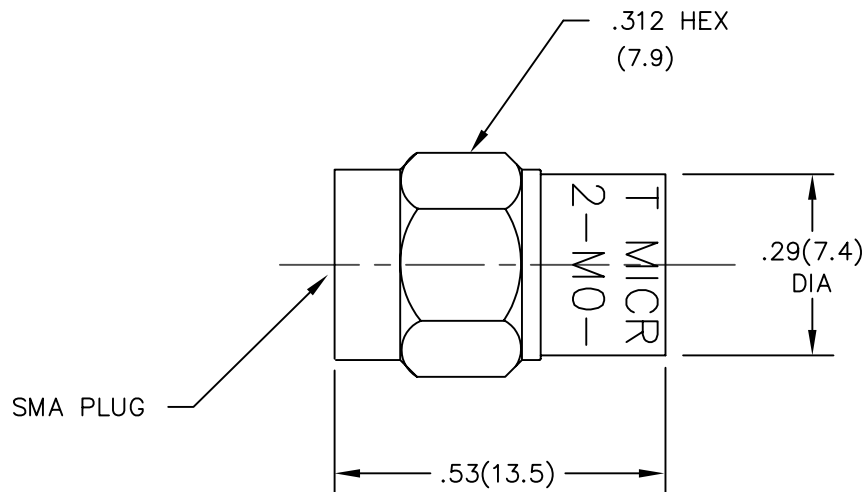

REV.	DESCRIPTION	DATE
-	RELEASED	3/3/92
A	ECN 12113	9/21/92
B	ECN 13044	10/27/93
B1	ADDED TITLEBLOCK	7/21/05
C	ECN 20673	1/27/06

NOTICE: The information contained in this drawing is proprietary and must not be used without the permission of Emerson Network Power.

UNLESS OTHERWISE NOTED DIMENSIONS ARE IN INCHES AND TOLERANCES ARE:
 3 PLACE DECIMALS ±.005
 2 PLACE DECIMALS ±.02
 FRACTIONS ±1/64
 PARALLELITY: T.I.R. _____
 FLATNESS: T.I.R. _____
 CONCENTRICITY: T.I.R. _____
 ANGLES AND PERPENDICULARITY: ±1'

CAGE CODE 34078		MIDWEST MICROWAVE	
		TITLE SMA PLUG SHORT CIRCUIT OUTLINE DRAWING	
		DRAWN/DATE A.BEATTY 2/26/92	ENG./DATE G.KOZAK 3/2/92
DRAWING NUMBER SHT-2172-M0-SMA-02-01		REV. C	
CHECKED/DATE A.BEATTY 2/26/92		APPROVED/DATE	
SCALE: 5=1		SHEET 1 of 1	